

## MODEL – HTF / HTR

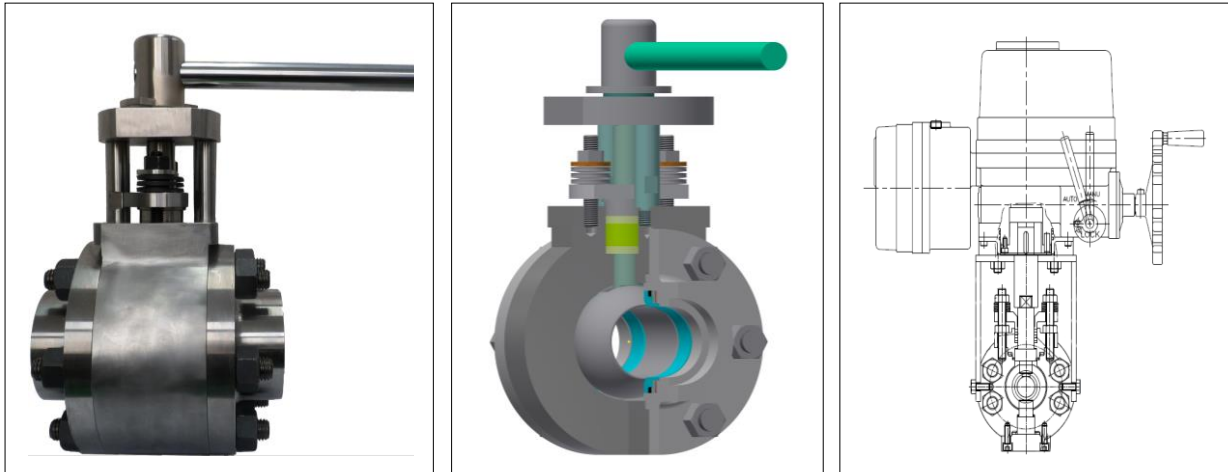

### STANDARD MATERIALS SPECIFICATIONS

PART NAME	MATERIALS
BODY	A105, A182-F91/F22/F316, etc
BALL	Cr Alloy Steel, 440C, 616SS, etc
STEM	Cr Alloy Steel
SEAT RING	Alloy Steel
SEAT SEAL	Graphite
SEAT LOAD RING	Alloy Steel
SEAT SPRING	Inconel
GASKET	Graphite + 304SS
PACKING	Graphite

- 1) Valve Size: 1/2" ~ 4"
- 2) Applicable Rating: ASME Class 600 ~ Class 2500
- 3) Temperature: Max. 600°C
- 4) Code & Standard: API, BS, ASME, ASTM  
Designed by ASME B16.11 /16.34 /16.5 /BS5351  
Tested by API 598

- 5) Constructions
  - \* Three-piece Type /Floating Ball Type
  - \* End Connection: Socket-welded and Butt Weld
  - \* Full Bore & Reduce Bore/Blow-out Proof Stem
  - \* Double Seal, Double Block & Bleed
  - \* Pressure Relieving Seats /Live-loading System
  - \* Fire Safety Construction: API 607

#### 6) Operations

- \* Lever (L) , Gear (G)
- \* Electric Actuator (E), Pneumatic Actuator (P)

### MODEL NUMBERING.

[HTR / HTF – SIZE – RATING – END CONNECTION – OPERATION]

ex.1) Shut off Valve Ball, Reducer bore, 50A,1500CLASS,SW,A105 WITH MOTOR ACTUATOR,440V,3PH,H/W  
=> **Model Number: HTR-50-1500-SW-E**

# HT METAL BALL VALVES

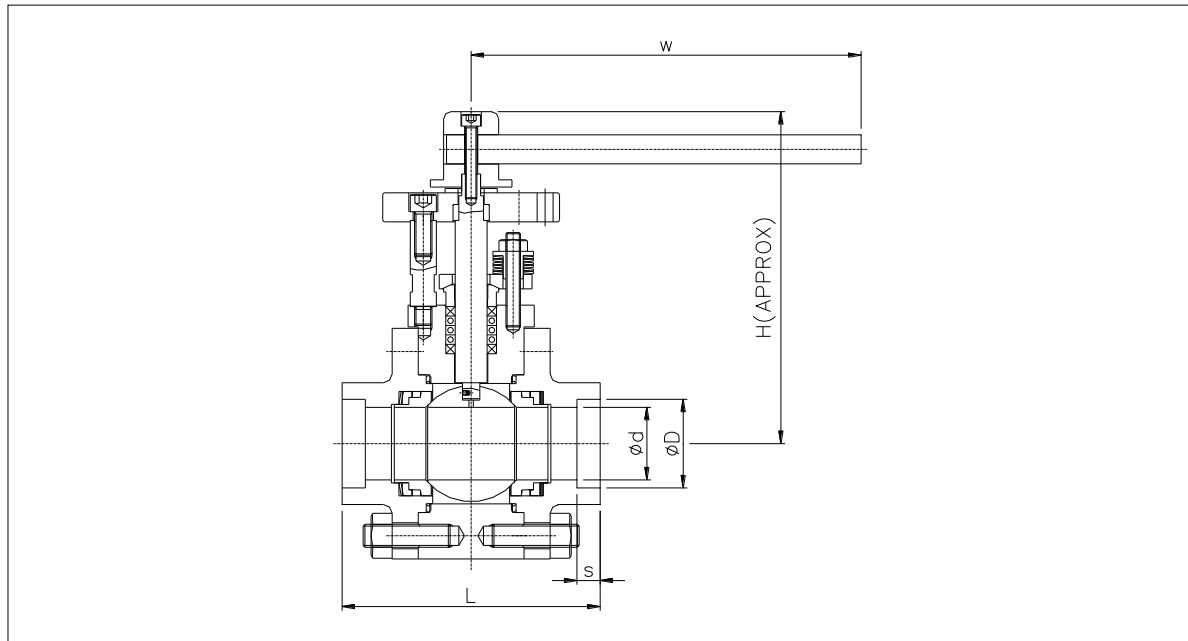

## - Side Entry - Reduce Bore (Model – HTR)

Division	Demension		Reduce Bore												
			600			1500(900)			2500			4500			
Size	D	T	L	D	H	L	D	H	L	D	H	L	D	H	
1/2	15A	21.8	10	170	11	55	170	11	55	170	11	60	170	11	75
3/4	20A	27.2	10	170	11	55	170	11	55	170	11	60	170	11	75
1	25A	34.1	10	170	16	80	190	16	80	215	16	90	250	16	110
1-1/4	32A	42.8	13	265	25	125	190	16	80	215	16	90	280	16	110
1-1/2	40A	48.9	13	265	25	125	190	16	80	215	16	90	280	16	110
2	50A	61.4	16	330	35	175	290	25	125	290	25	125	330	25	130

## - Side Entry - Full Bore (Model – HTF)

Division	Demension		Full Bore									
			150 ~ 600			1500(900)			2500			
Size	D	T	L	D	H	L	D	H	L	D	H	
1/2	15A	21.8	10	170	11	55	170	11	55	170	11	60
3/4	20A	27.2	10	170	16	80	170	16	80	170	11	60
1	25A	34.1	10	220	25	125	220	20	125	220	16	90
1-1/4	32A	42.8	13	285	30	150	285	25	125	285	25	120
1-1/2	40A	48.9	13	285	35	175	285	32	160	285	25	120
2	50A	61.4	16	310	42	210	310	42	210	370	35	150
2-1/2	65A	Butt Weld		330	60	300	419	50	250	508	42	185
3	80A			356	68	340	470	60	300	578	50	220
4	100A			431	90	450	546	80	400	673	60	260

# HT METAL BALL VALVES

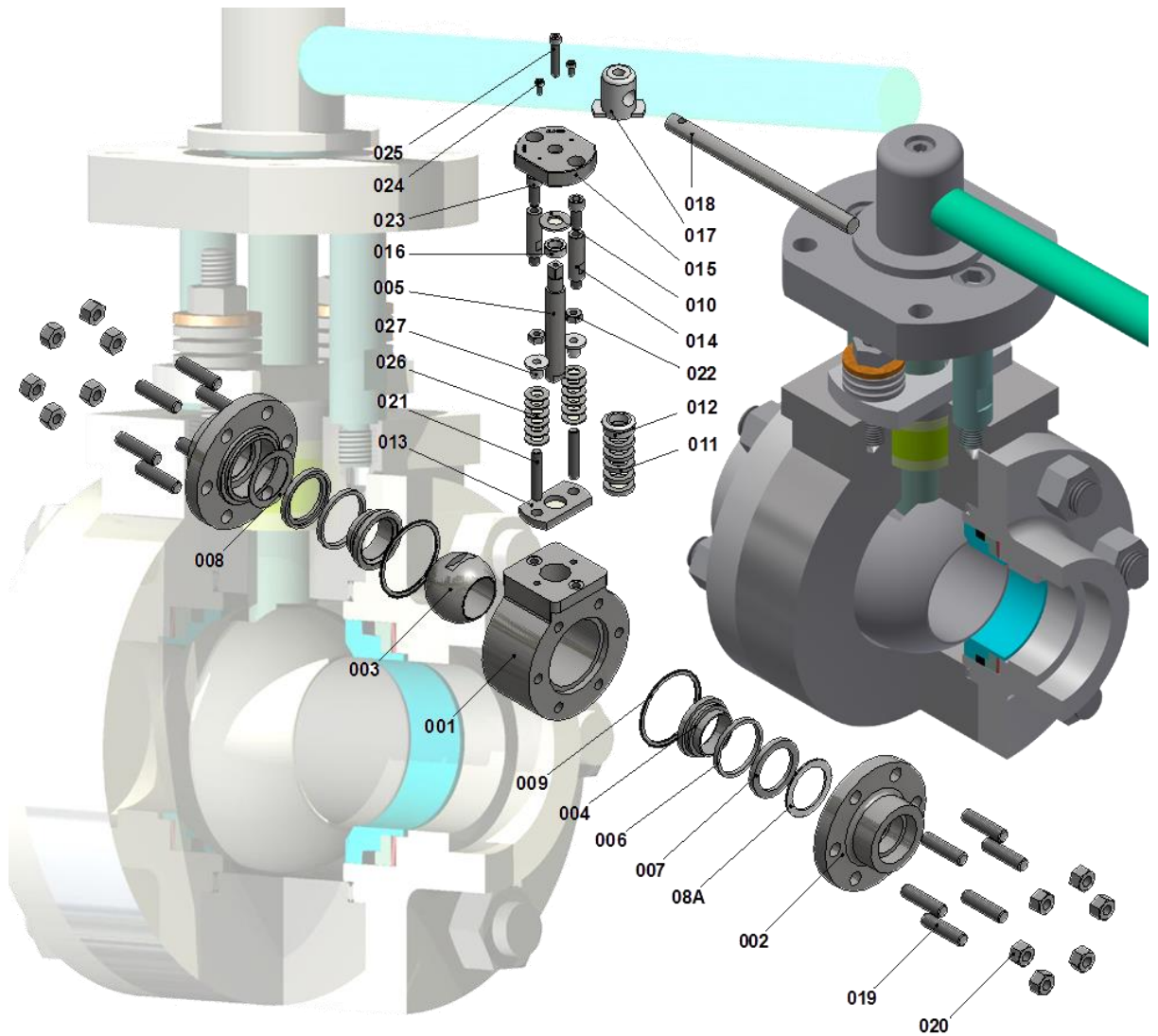

NO.	PART NAME	MATERIAL	NO.	PART NAME	MATERIAL
001	BODY	A105	013	GLAND FLANGE	A105
002	CONNECTOR	A105	014	YOKE BAR	A564-630 (H1100)
003	BALL	440C	015	YOKE FLANGE	A105
004	SEAT RING	440C	016	STEM BEARING	304
005	STEM	A564-630	017	LEVER CONNECTOR	A276-304
006	SEAT SEAL	GRAPHITE	018	LEVER	A105
007	SEAT LOAD RING	440C	019	CONNECTOR BOLT	A193-B7
008	SEAT SPRING	630 (H900)	020	CONNECTOR NUT	A194-2H
08A	SEAT SPRING SPACER	630 (H900)	021	GLAND BOLT	A193-B7
009	BODY GASKET	GRAPHITE+304	022	GLAND NUT	A194-2H
010	LEVER CONNECTOR WASHER	A276-304	023	YOKE FLANGE BOLT	SCM435
011	PACKING	GRAPHITE	024	LEVER CONNECTOR BOLT	SCM435
012	PACKING GLAND	A276-304	025	ROTATION LOCKER	SCM435