

HT METAL BALL VALVES

MODEL . HTR / HTF

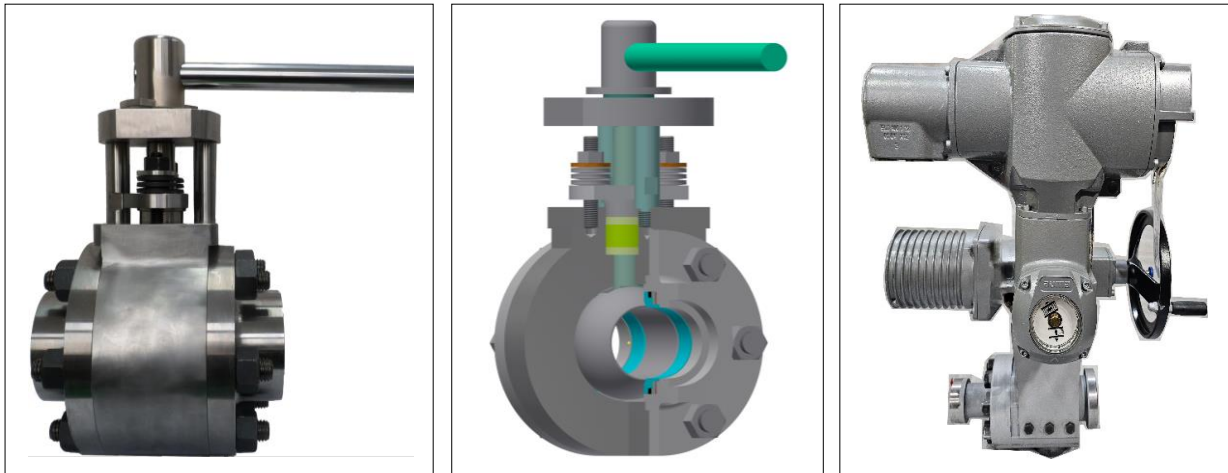

STANDARD MATERIALS SPECIFICATIONS

PART NAME	MATERIALS
BODY	A105, A182-F91/F22/F316, etc
BALL	Cr Alloy Steel, 440C, 616SS, etc
STEM	Cr Alloy Steel
SEAT RING	Alloy Steel
SEAT SEAL	Graphite
SEAT LOAD RING	Alloy Steel
SEAT SPRING	Inconel
GASKET	Graphite + 304SS
PACKING	Graphite

- 1) Valve Size: 1/2" ~ 4"
- 2) Applicable Rating: ASME Class 600 ~ Class 2500
- 3) Temperature: Max. 600°C
- 4) Code & Standard: API, BS, ASME, ASTM
Designed by ASME B16.11 /16.34 /16.5 /BS5351
Tested by API 598
- 5) Constructions
 - * Three-piece Type /Floating Ball Type
 - * End Connection: Socket-welded and Butt Weld
 - * Full Bore & Reduce Bore/Blow-out Proof Stem
 - * Double Seal, Double Block & Bleed
 - * Pressure Relieving Seats /Live-loading System
 - * Fire Safety Construction: API 607

6) Operations

- * Lever (L) , Gear (G)
- * Electric Actuator (E), Pneumatic Actuator (P)

MODEL NUMBERING.

[HTF/R – SIZE – RATING – END CONNECTION – OPERATION]

ex.1) Shut off Valve Ball, Reducing Bore, 50A,1500CLASS,SW,A105 WITH MOTOR ACTUATOR,440V,3PH,H/W
=> **Model Number: HTR-50-1500-SW-E**

HT METAL BALL VALVES

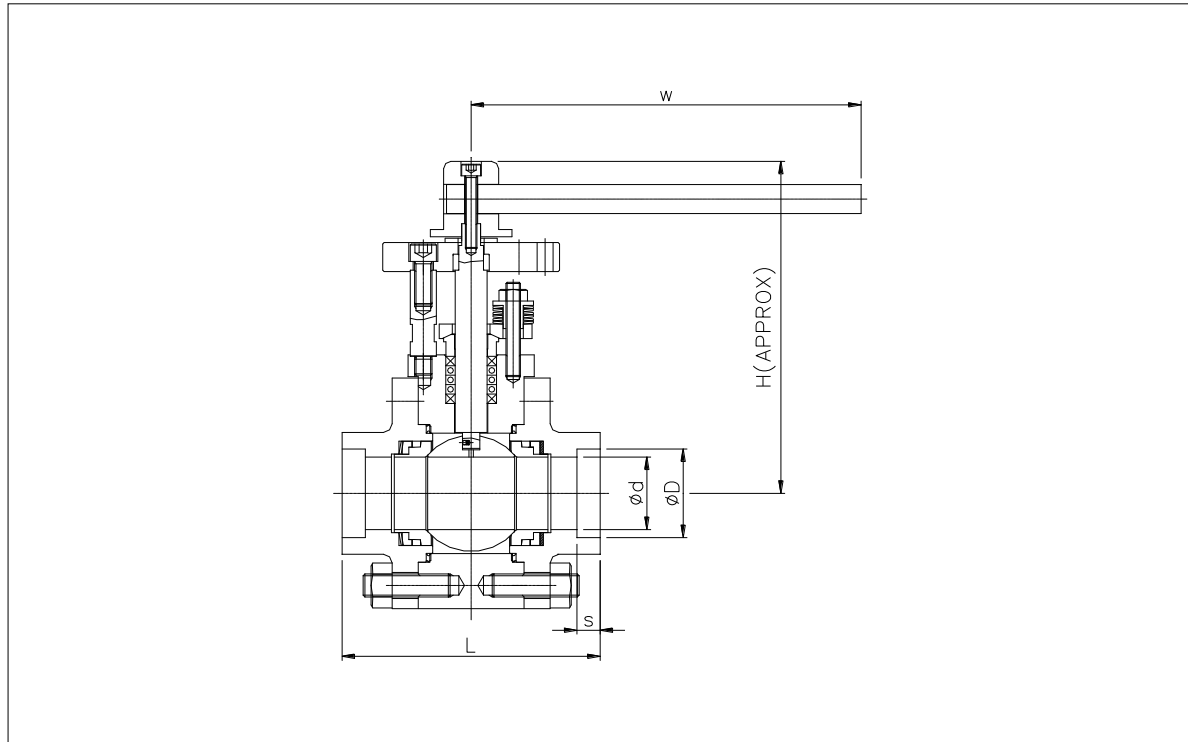

Side Entry-Reduce Bore (Model. HTR)

Division		Type		Reduce Bore											
		Dimension / Class		600			1500 (900)			2500			4500		
Size		D	T	L	d	H	L	d	H	L	d	H	L	d	H
1/2	15A	21.8	10	170	11	55	170	11	55	170	11	60	170	11	75
3/4	20A	27.2	10	170	11	55	170	11	55	170	11	60	170	11	75
1	25A	34.1	10	170	16	80	190	16	80	215	16	90	250	16	110
1-1/4	32A	42.8	13	265	25	125	190	16	80	215	16	90	280	16	110
1-1/2	40A	48.9	13	265	25	125	190	16	80	215	16	90	280	16	110
2	50A	61.4	16	330	35	175	290	25	125	290	25	125	330	25	130

Side Entry-Full Bore (Model. HTF)

Division		Type		Full Bore								
		Demension / Class		150 ~ 600			1500 (900)			2500		
Size		D	T	L	d	H	L	d	H	L	d	H
1/2	15A	21.8	10	170	11	55	170	11	55	170	11	60
3/4	20A	27.2	10	170	16	80	170	16	80	170	11	60
1	25A	34.1	10	220	25	125	220	25	125	220	16	90
1-1/4	32A	42.8	13	285	30	150	285	25	125	285	25	120
1-1/2	40A	48.9	13	285	35	175	285	32	160	285	25	120
2	50A	61.4	16	310	42	210	310	42	210	370	35	150
2-1/2	65A	Butt Weld		330	60	300	419	50	250	508	42	185
3	80A			356	68	340	470	60	300	578	50	220
4	100A			431	90	450	546	80	400	673	60	260

HT METAL BALL VALVES

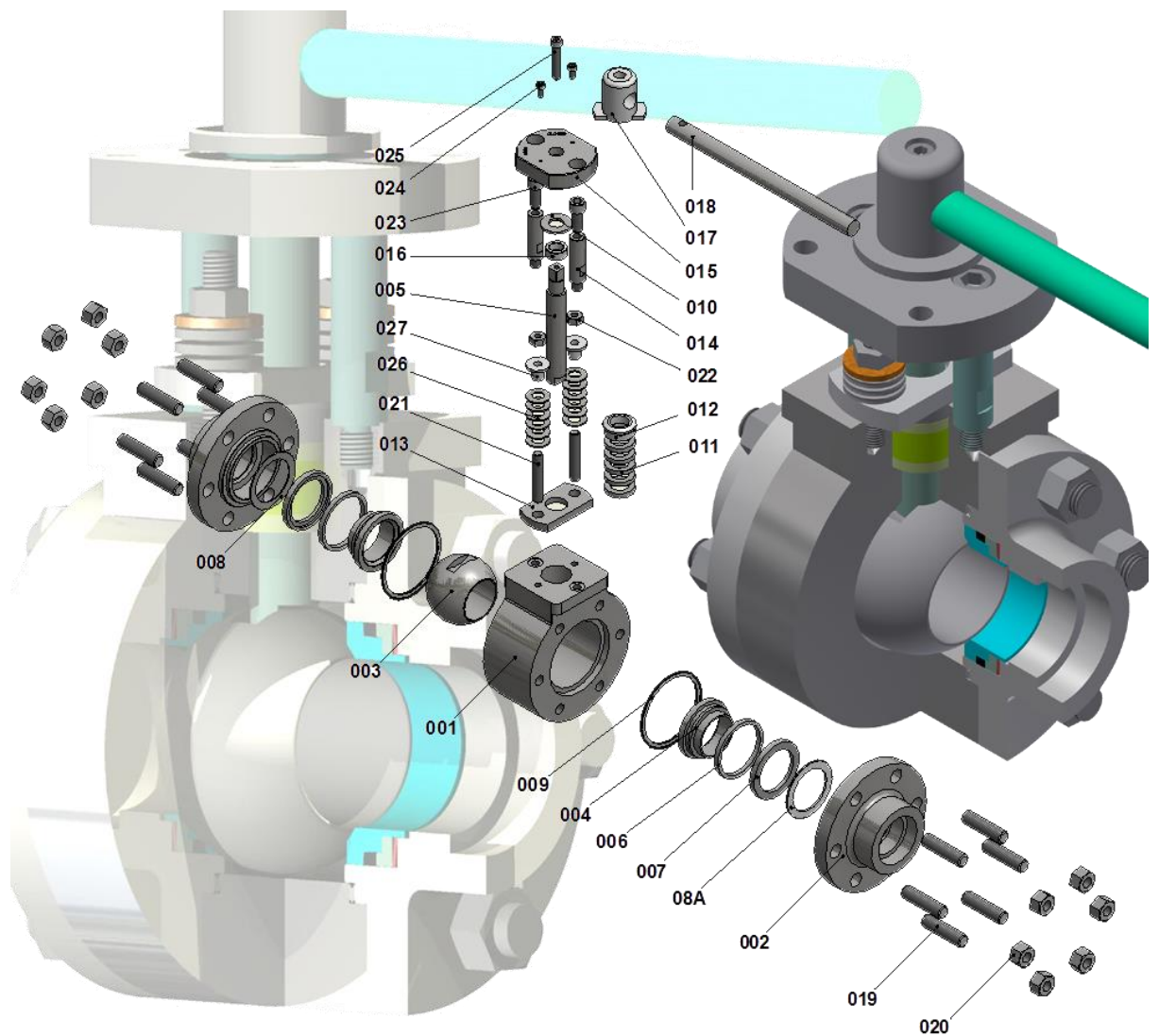

NO.	PART NAME	MATERIAL	NO.	PART NAME	MATERIAL
001	BODY	A105	013	GLAND FLANGE	A105
002	CONNECTOR	A105	014	YOKE BAR	A564-630 (H1100)
003	BALL	440C	015	YOKE FLANGE	A105
004	SEAT RING	440C	016	STEM BEARING	304
005	STEM	A564-630	017	LEVER CONNECTOR	A276-304
006	SEAT SEAL	GRAPHITE	018	LEVER	A105
007	SEAT LOAD RING	440C	019	CONNECTOR BOLT	A193-B7
008	SEAT SPRING	630 (H900)	020	CONNECTOR NUT	A194-2H
08A	SEAT SPRING SPACER	630 (H900)	021	GLAND BOLT	A193-B7
009	BODY GASKET	GRAPHITE+304	022	GLAND NUT	A194-2H
010	LEVER CONNECTOR WASHER	A276-304	023	YOKE FLANGE BOLT	SCM435
011	PACKING	GRAPHITE	024	LEVER CONNECTOR BOLT	SCM435
012	PACKING GLAND	A276-304	025	ROTATION LOCKER	SCM435